

The background features abstract, overlapping green geometric shapes, primarily triangles and polygons, in various shades of green, creating a modern and dynamic visual effect.

Cherlagudem

Sangareddy



Group 11

P Balamurugan
Gopal Krishna Gautam
Jagdish Bangarwa
Adarsh Kumar
Digvijay Sanjay Patil

District In Brief

- ▶ Earlier part of Medak district
- ▶ Houses
 - ▶ Bharat Heavy Electricals Limited
 - ▶ Ordinance Factory
 - ▶ Bharat Dynamics Limited

Geographical Area(SqKm)	4403
Revenue Village	601
Population	15,26,628 (65% Rural; 35% Urban)
Occupation of working population	Cultivators - 15.9% Agricultural Labourers - 43.44% Household Industries - 2.5% Others - 38.16%



Village In Brief



Name	Cherlagudem
Population	1699 (M: 842; F: 857)
SC Population	164 (M:81;F:83)
BC Population	1637 (M:668;F:699)
OC Population	214 (M:115;F:99)
ST Population	0
0-6 Age Group	147 (M:75; F:72)
Literacy	80.63%
No of Households	388
Households with IHHL	100%
Types of Houses	Brick House - 60% Kucha House - 40% (Wooden/Stone Slab)

IN BRIEF...

1. Road : Concrete Road in interior of village & Bitumen Main Road; presence of kucha roads
2. Source of Drinking Water :
 1. 2 Overhead water tanks are operational
 2. The water into tanks is supplied through Borewells.
 3. Every household has been provided piped water connection through Mission Bhagiratha
3. Primary Health Center : Kandi
4. Sub Center : 1
5. Post Office : Kandi
6. Electric Connection : 100% metered electricity. Electricity was supplied for 90% of duration. However, villagers claim electricity is available 24 hours.
7. 4 CCTV cameras are installed in villagers with monitor in Panchayat Bhavan
8. Entire Village has street lights installed
9. 1 Primary School, 2 Aanganwadi, 2 Community hall 1 each for Backward Caste and Scheduled Caste, 1 FPS

SOCIAL AND RESOURCE MAPS

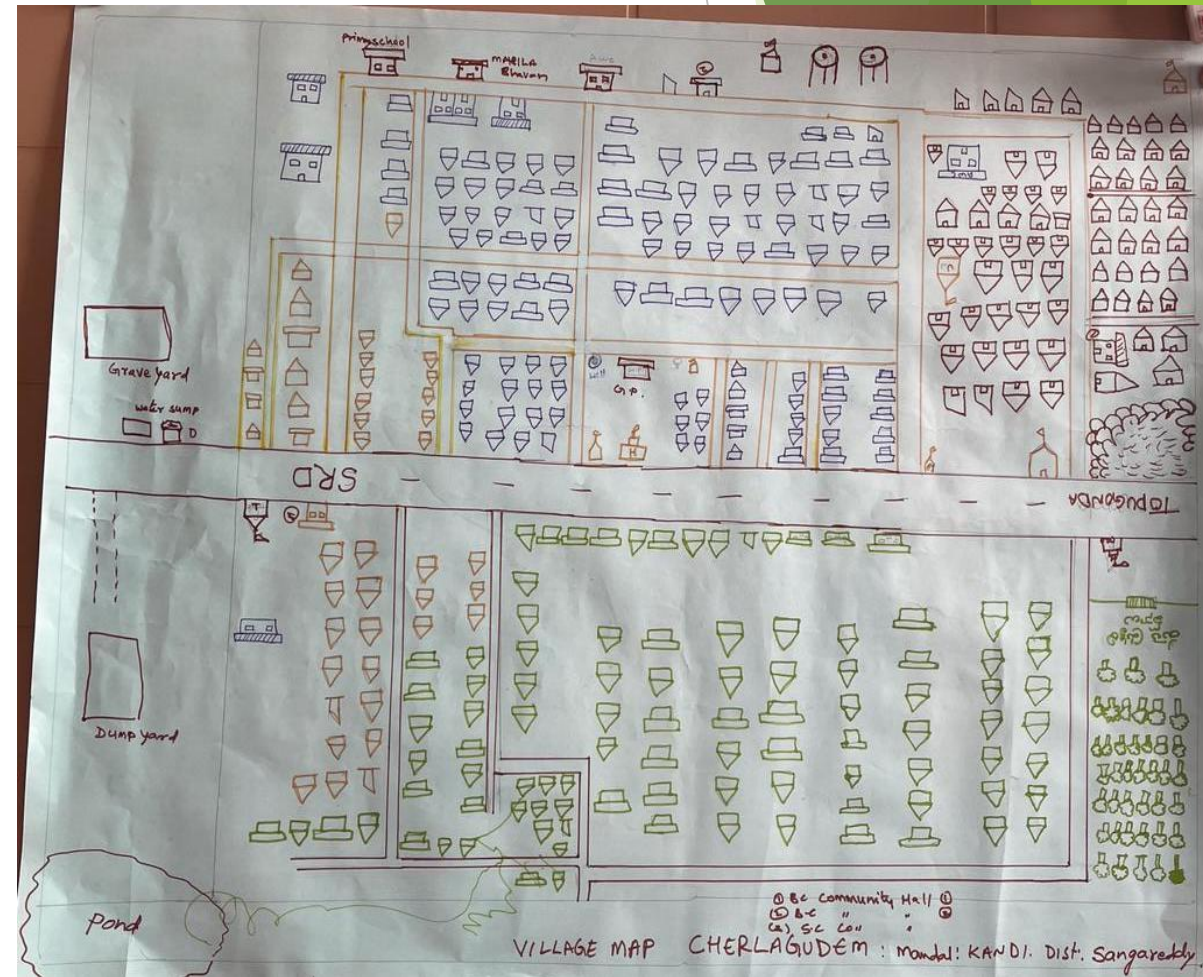
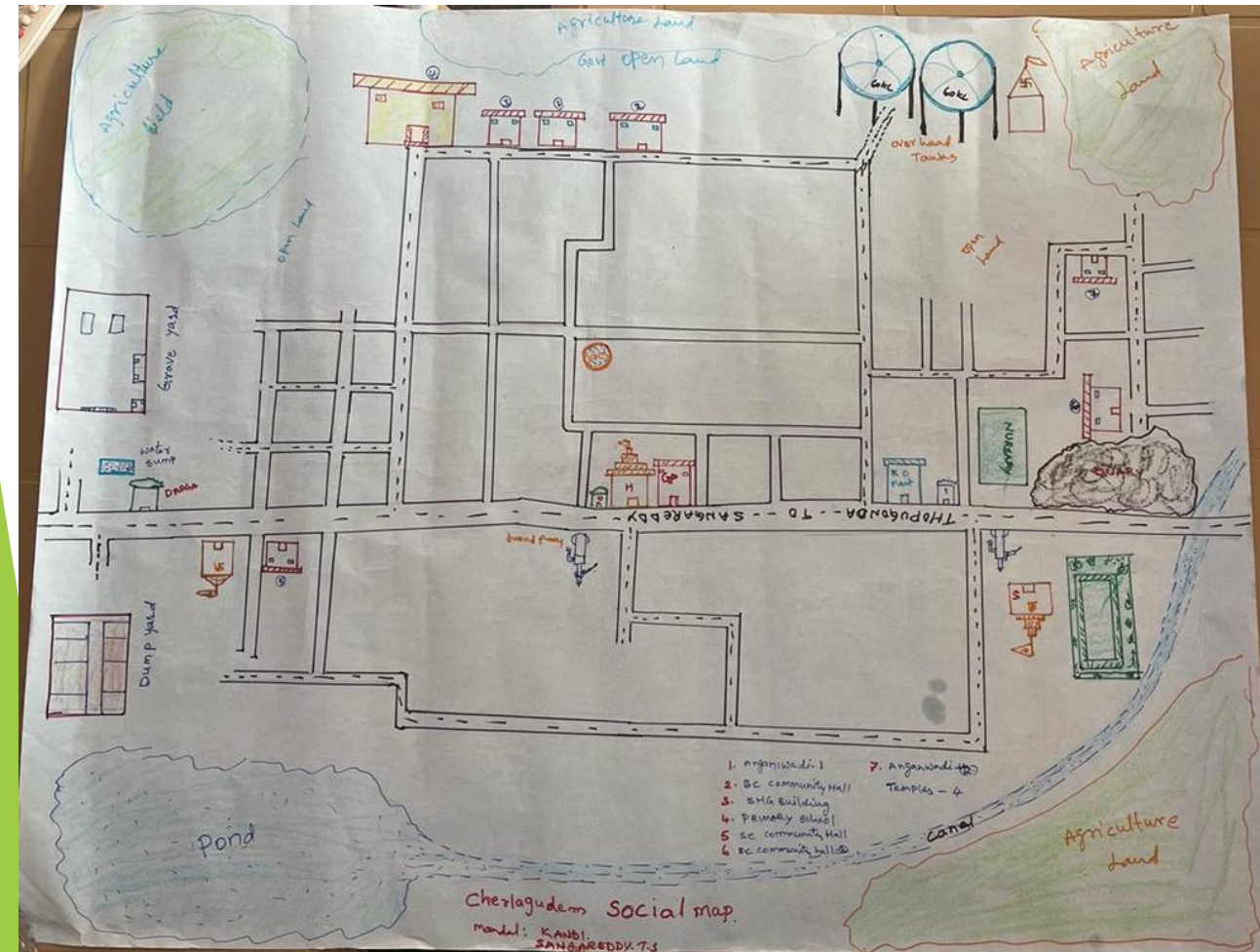

SOCIAL MAP



Dumping Yard



అంగన్ వాడీ కేంద్రం కానవాడ

గ్రా..పం.. చెర్ర గూడెం

మం., సంగారెడ్డి, జిల్లా మెదక్, PIN: 502285.





IMPORTANT TIMELINES

EVENT	YEAR
Electricity	1979
First SHG	1999
First Overhead Tank	2005
100% Electrification	2014
ODF Declaration	2016
Construction of PCC Road	2017
Nursery	2018
RO Plant	2019
Palle Prakriti Vanam	2019/2020

EDUCATION

❖ Infrastructure

- Aanganwadi Center : 2
- Primary School : 1
- High School : 0

❖ AANGANWADI

- Anganwadi caters to Kids, Pregnant and Lactating women. They undertake activities like vaccination, small games for cognitive development, providing food, measurement of growth
- 30 Children are registered with Aanganwadi center.
- First Aanganwadi has just one room with no boundary wall.
- Second Aanganwadi has good building with clean toilets, proper boundary wall very near to houses of residents.
- These Children were given 1 egg/day along with meal consisting of rice, dal and some vegetable.
- Lactating and Pregnant women have been given 2 eggs on Wednesday and Sunday.
- Food is supplied by Akshay Patra





EDUCATION ...

- ▶ Infrastructure : 2 Class rooms, lack of benches, No Computer/Multimedia; separate restrooms for boys & girls
- ▶ Number of Students : 65
- ▶ No. of Teachers : 3
- ▶ Medium : Telugu
- ▶ MDM : Provided by Akshay Patra
- ▶ Problem
 1. Learning Level : On interaction with children it was observed that only few children were able to read English letters and words. Those who were able to read did not understand the meaning of the words or sentence.
 2. Exit from Government School System : All the prosperous family of the village sent their children to private school. Only those people who could not afford (like Wadhera Community) private school sent their children to government school
 3. Attendance in School : Wadhera community does seasonal migration to Hyderabad. Therefore, Children of Wadhera Community are irregular in school. The result of irregular attendance was reflected in their learning level.
 4. Composition of MDM : MDM consists of Rice and Sambhar(2 days egg). While quality of food was good. This composition is not suitable for growing kids.
 5. Boys vs Girls : There are more girls in government school as parents send boys to private school.



HEALTH

- ▶ Nearest PHC : Kandi
- ▶ No. of Doctors in the PHC : 01
- ▶ No. of Nurses : 17 members
- ▶ Day of Visit of ANMs : Monthly 2 days (Thursdays and 2nd Saturday) No. of Children Immunized : 100%
- ▶ Presence of a private nurse in the village
- ▶ Nearest multi speciality hospital in Sangareddy & Hyderabad



POVERTY, UNEMPLOYMENT AND LIVELIHOOD

- ▶ There are 388 households in the village of which around 100+ families are in BPL category.
- ▶ There are 2 central government employees and 3 state government employees. 36 individual are unemployed.
- ▶ The primary source of income for the people is Agriculture. Some families have started small shops, flour mills, bangle shops, auto service, bus service etc.
- ▶ BPL households mainly comprises of Vaddera community. This community is traditionally engaged in stone cutting work. Changing times has reduced their income significantly as input cost has increased and market has remained stagnant. They also work as agricultural labour during farming season.
- ▶ Around half of the family does not have any significant land holding. These families work as agricultural laborer.

FAIR PRICE SHOP

No Of FPS	1
No Of Cards	435
No of Priority Household Cards	407
No of AAY Cards	28

- Only Rice and no dal or oil or sugar
- Quality and time issues
- Technological Barriers



SELF HELP GROUPS

No. of SHG	31 (255 Women Covered)	Community	No. of Families Covered
Bank Linkages through SHG	31	SC	22
Defaulting SHG	2	ST	0
SHG among Vaddera	3	BC	191
Physically Handicapped	1	Minority	05
		OC	36

Loan Limit/SHG : Rs 5 Lakhs, Loan Per Individual : Rs 50,000,
Repayment Period : 36 Months ROI : 13%
Interest subsidy by government if
loan repayment done on time





SELF HELP GROUPS

1. Oldest SHG : 1999
2. Oldest SHG with no change in membership: 2005

Structure

1. Community Coordinator -> Leader 1 & Leader 2 -> Book Keeper
2. In 2003, Indira Kranthi Program was started in Sangareddy district under which 26 SHG were formed. In 2004 all SHG have been federated into VILLAGE ORGANISATIONS by name "Cherlagudem Village Women Mutually Aided Cooperative Thrift and Credit Society Federation Limited".
3. This VO is registered under AP Mutually Aided Cooperative Society Act



SOCIAL SECURITY SCHEMES

- ▶ Declared ODF in 2016, thanks to Swachch Bharat Mission
- ▶ Supply of water through Mission Bhagiratha
- ▶ Successful implementation of Rytu Bandu
- ▶ Implementation of MGNREGA
- ▶ Nursery & Palle Prakruti Vanam
- ▶ Solid Waste Management & Compost Yard
- ▶ Common RO





AGRICULTURE PROFILE

Total Geographical Area	1294 Acre
Cultivated Agriculture Land	1013 Acre
Government Land	58 Acre
Major Crop in Acres	
Cotton	802 Acre
Paddy	102 Acre
Turneric	24 Acre
Vegetables	22 Acre
Red Gram	52 Acre
Horticulture Poly house	2 Acre
Agriculture borewell	252
No. of Crop Loans given/renewed	160/140

AGRICULTURE ...

- Village lacks piped irrigation facility. Thus, entire irrigation is from borewell. Consequently, ground water level has dropped to more than 550 feet.
- Electricity for borewell is provided almost free of cost. Only ₹30/month is charged for connection.
- Villagers do not have access to Crop insurance as their land holding is small so banks do not entertain them.
- Farmers have KISAN CREDIT CARD through which they get crop loan at 7%. If loan repaid within 1 year interest is waived off









Thank You...

